

Partlist



Nord Fox Aluminum
Facade Systems

NordFox company has been in facade technology business for almost 10 years and proved itself as a reliable partner with flexible terms and high-quality product. Projects commissioned all over Russia rose beyond 5000 long time ago. These numbers demonstrate steady shoulder-to-shoulder work of NordFox managers and designers with architects, contractors and installation personnel.

Structural element of NordFox System has passed durability test, contains very few parts and is 95% ready to use - all these features help reducing human factor during installation.

At the present moment, our design department is the biggest among all manufacturers of these systems. NordFox designers are available in our representation offices in many cities of Russia, so that they can provide authorial supervision at their projects.

Our sales office does business accounting for a standard zone of a particular building and ALWAYS based on the static analysis, allowing us to draw up an offer to a Customer as accurate as possible.

Our company is always ready for new missions and projects, our design department will elaborate any technical solutions meeting the customer's requests.

Facade Systems

<i>MTC-v-100 Visible fixing of ceramic tiles</i>	3
<i>MTH-v-100 Concealed fixing of cassette panels</i>	4
<i>MTA-v-100 Visible fixing of plate materials</i>	5
<i>MLV-v-20 Concealed fixing of finish panels with the use of Keil anchors</i>	6
<i>MLV-v-20 Concealed fixing of finish panels with the use of Keil anchors and Trag-profiles</i>	7
<i>MLV-v-20 Concealed fixing of natural stone panels by saw kerf method</i>	8
<i>MTC-v-350 Terracota tiles fixing</i>	9
<i>MTC-v-350 Saw kerf decorative clinker brick tiles frame fixing</i>	10
<i>MTC-v-350 Slab-to-slab decorative clinker brick tiles frame fixing</i>	11
<i>MLK-v-300 Visible fixing of thin porcelain tiles</i>	12
<i>MLK-v-300 Cassette fixing of thin porcelain tiles</i>	13
<i>MLK-v-300 Deco Decorative finish plates fixing at sandwich panels</i>	14

Interfloor Fixing System

<i>H section</i>	15
<i>DT-section</i>	16
Brackets	
<i>MacFox</i>	17
<i>X Fox</i>	19
<i>U Fox</i>	21
<i>UT Fox</i>	23
<i>Thermal insulators</i>	25
<i>Distance elements</i>	26
<i>Connection elements</i>	27
<i>Profiles</i>	28
<i>Clamps] Profile</i>	37
<i>Position holders for cassette facade</i>	41
<i>Hangers</i>	43
<i>Mounting elements</i>	44

Visible fixing of ceramic tiles

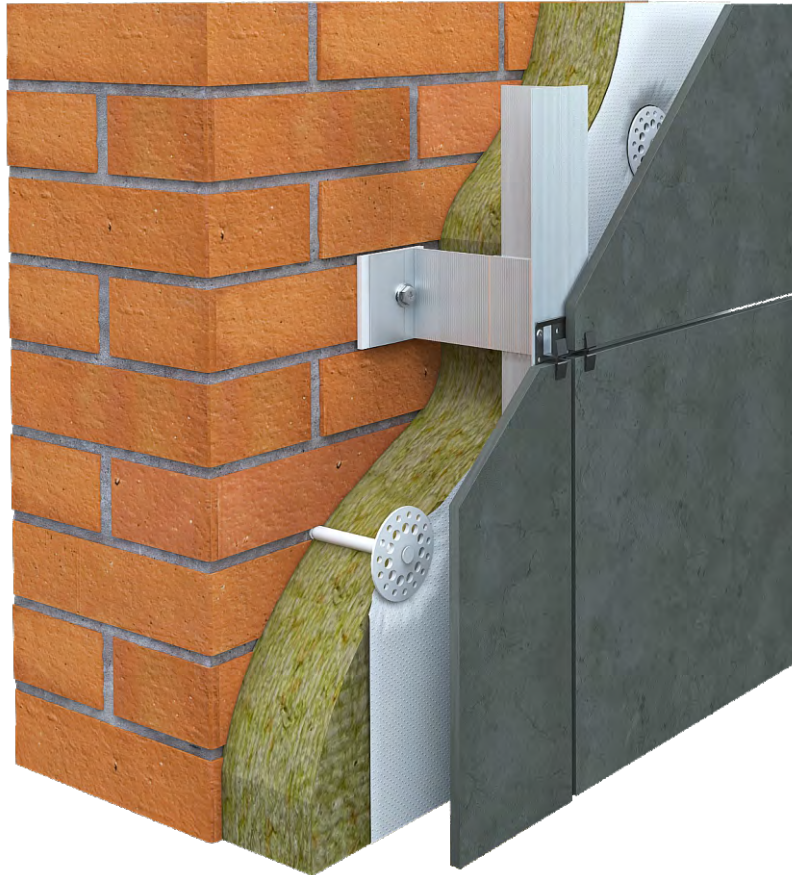

*Five standard sizes of clamps for fixing facing tiles of various thickness: 8, 10, 12, 13.5 and 16mm.
In our product range, there are special-purpose clamps that can be used without referencing the layout of tiles with the joint between vertical guides and that help preventing horizontal displacement of tiles.
1200x600 tiles can be secured with four lugs, even above the fire openings.*

*Facing material: ceramic granite tiles 8 to 16 mm thick.
Mounting configuration of facing material: visible clamps.
Max facing sizes: 1000x1000mm, 1200x600mm (horizontally and vertically).
Offset of facing from the wall surface: 58 to 519mm.*

*Mounting configuration of brackets:
- standard: mounting to the walls
- interfloor: mounting in the floor slabs.*

Max allowed height: no height restrictions.

Concealed fixing of cassette panels

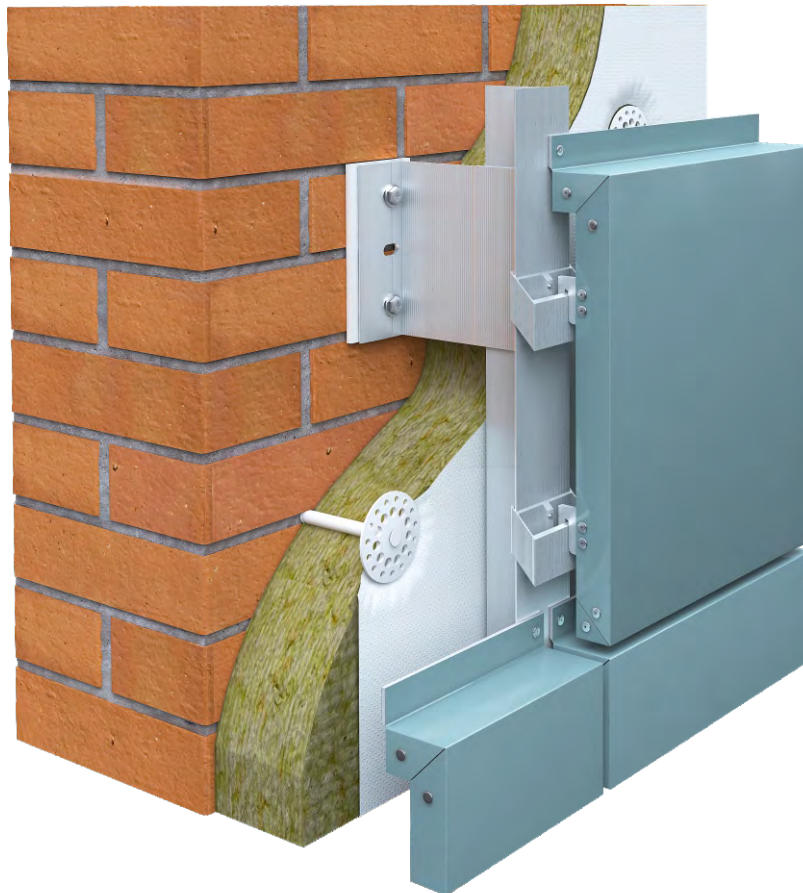

The system is available in two configurations.

The first option is a system standardized to fit into other system types: well-known T-section that can be combined with other systems. Adjustment range of vertical rustic joint is wide due to wide carriages (80mm).

The second option: A harder K-section is used. Cassettes may be mounted with the use of latches as well as by means of cuts at cassette edges.

General information for both options: Fasteners for assembling cassettes are included in the system delivery set. Position of carriages can be adjusted after cassettes are installed and are fixed by a preset screw.

Installation of wider cassettes is possible with the use of clips.

Facing material: cassettes made of sheet composite materials.

Mounting configuration of facing material: by means of latches.

Max facing sizes: 1500x3000mm (horizontally and vertically).

Offset of facing from the wall surface: 97 to 600mm.

Mounting configuration of brackets:

- standard: mounting to the walls*
- interfloor: mounting in the floor slabs.*

Max allowed height: no height restrictions.

Visible fixing of plate materials



This mounting configuration of facing sheets is the simplest and cheapest.

Facing material: panels made of fibre cement, HPL, RockPanels.

Mounting configuration of facing material: pop-rivets or tapping screws.

Max facing sizes: 4300x2200 (horizontally and vertically).

Offset of facing from the wall surface: 53 to 516mm.

Mounting configuration of brackets:

- standard: mounting to the walls*
- interfloor: mounting in the floor slabs.*

Max allowed height: no height restrictions.

Concealed fixing of finish panels with Keil anchors



Depending of facing type, facing tiles can be secured by Keil anchors, self-tapping screws, by bolts into embedded facing parts, or adhesive anchors (pins). In systems with "reinforced" horizontal sections, referencing of vertical joints to vertical sections of the system is not necessary, and facing may be staggered. Joints of minimum size can be placed up to 2mm.

Facing tiles can be placed at any angle in vertical plane. Quick mounting and dismounting of facing.

Facing material: tiles of ceramic granite, natural stone, HPL, concrete panels reinforced with fibreglass (fibre glass mesh), haydite concrete panels with natural-stone or single-glass surface, textured glassfibre reinforced concrete panels, agglomerate granite tiles, fibre cement tiles.

Mounting configuration of facing material: concealed fixing

Max facing sizes: 4300x2200mm (horizontally and vertically).

Offset of facing from the wall surface: 62 to 555mm.

Mounting configuration of brackets:

- standard: mounting to the walls*
- interfloor: mounting in the floor slabs.*

Max allowed height: no height restrictions.

Concealed fixing of finish panels with the use of Keil anchors and Trag-profiles

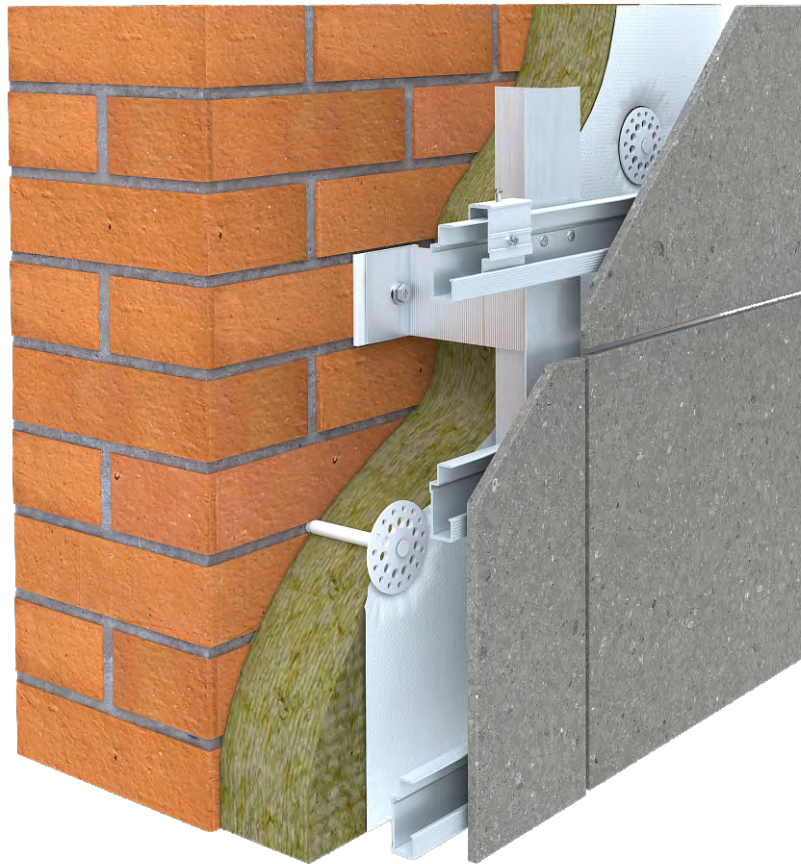

Depending of facing type, facing tiles can be secured by Keil anchors, self-tapping screws, by bolts into embedded facing parts, or adhesive anchors (pins). In systems with "reinforced" horizontal sections, referencing of vertical joints to vertical sections of the system is not necessary, and facing may be staggered. Joints of minimum size can be placed (up to 2mm) without additional tile surface finishing. Facing tiles can be placed at any angle in vertical plane. Quick mounting and dismanting of facing.

Facing material: tiles of ceramic granite, natural stone, HPL, concrete panels reinforced with fibreglass (fibre glass mesh), haydite concrete panels with natural-stone or single-glass surface, textured glassfibre reinforced concrete panels, agglomerate granite tiles, fibre cement tiles.

Mounting configuration of facing material: concealed fixing.

Max facing sizes: 4300x2200mm (horizontally and vertically).

Offset of facing from the wall surface: 62 to 555mm.

Mounting configuration of brackets:

- standard: mounting to the walls
- interfloor: mounting in the floor slabs.

Max allowed height: no height restrictions.

Concealed fixing of natural stone panels by saw kerf method

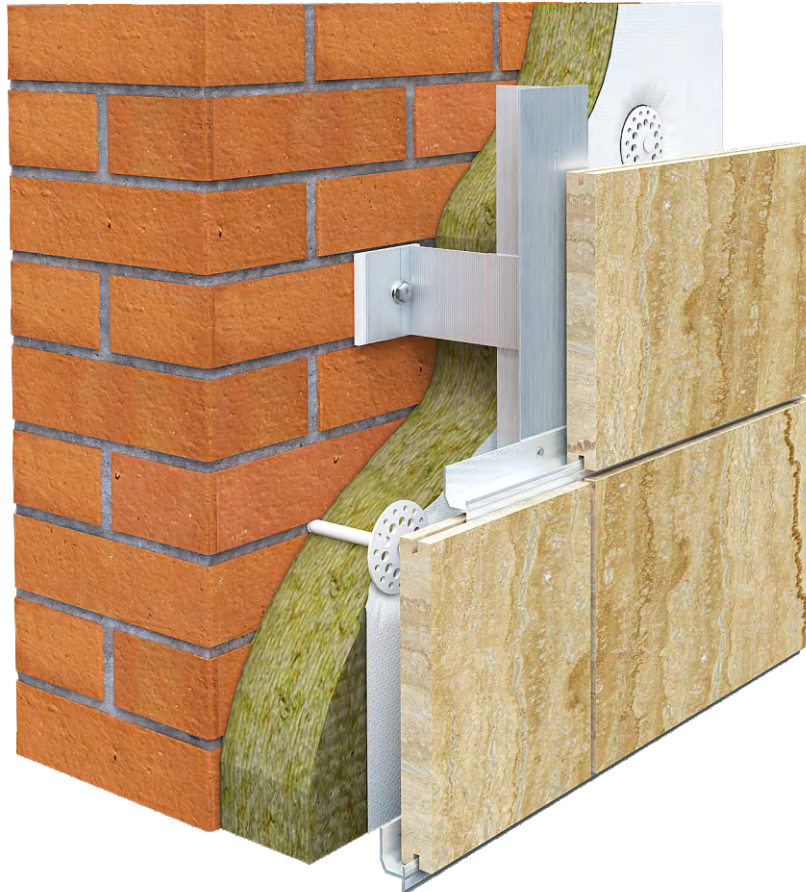

The system allows mounting all types of natural stones, e.g. medium-strength stones. In such systems, referencing of vertical joints to vertical sections of the system is not necessary, and facing may be staggered. Removable facing tiles can also be used.

Facing material: ceramic granite tiles, natural stone tiles, textured glassfibre reinforced concrete tiles, agglomerate granite tiles.

Mounting configuration of facing material: concealed mounting with cleats and bars.

Max facing sizes: 1500x1500mm, 1800x1250mm (horizontally and vertically).

Offset of facing from the wall surface: 62 to 540mm.

Mounting configuration of brackets:

- standard: mounting to the walls*
- interfloor: mounting in the floor slabs.*

Max allowed height: no height restrictions.

Terracota tiles fixing

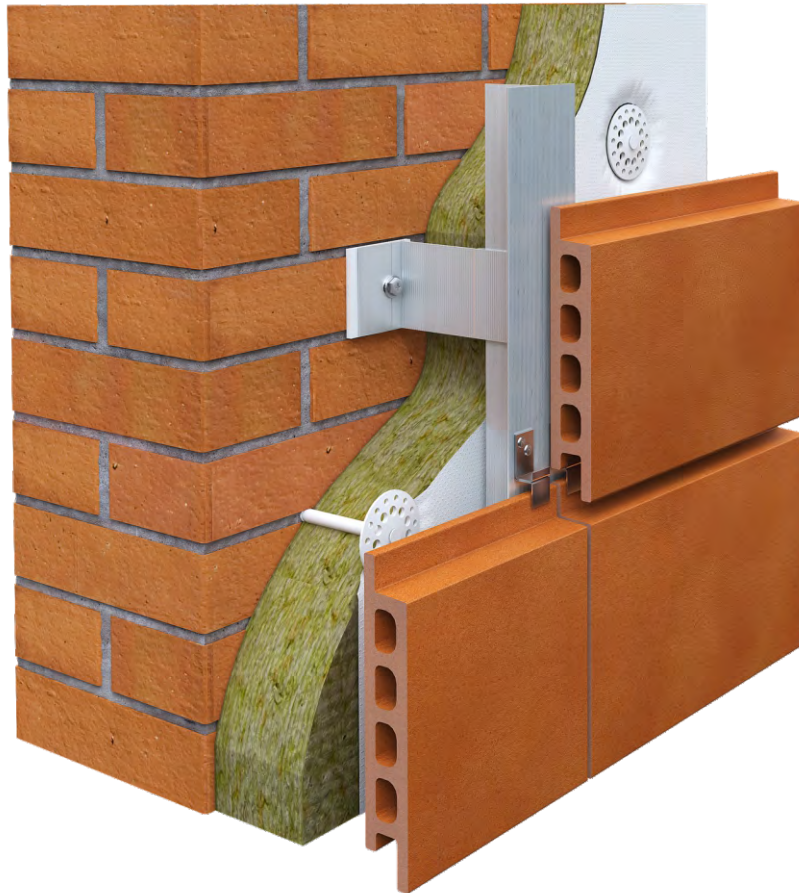

Wide range of aluminium and stainless-steel clamps and bars allows for mounting almost any types of tiles available on market. Both horizontal and vertical mounting is possible. EPDM (TEP) pressure clamps delivered with aluminium cleats and bars prevent vibration and horizontal displacement of tiles. When the system is mounted using bars, referencing of vertical joints to vertical sections of the system is not necessary, and facing may be staggered. Quick mounting and dismounting of tiles is made possible.

Facing material: solid and hollow ceramic tiles.

Mounting configuration of facing material: clamps, bars with concealed mounting.

Max facing sizes: 1800x600mm (horizontally and vertically).

Offset of facing from the wall surface: 62 to 600mm.

Mounting configuration of brackets:

- standard: mounting to the walls
- interfloor: mounting in the floor slabs.

Max allowed height: no height restrictions.

Saw kerf decorative clinker brick tiles frame fixing

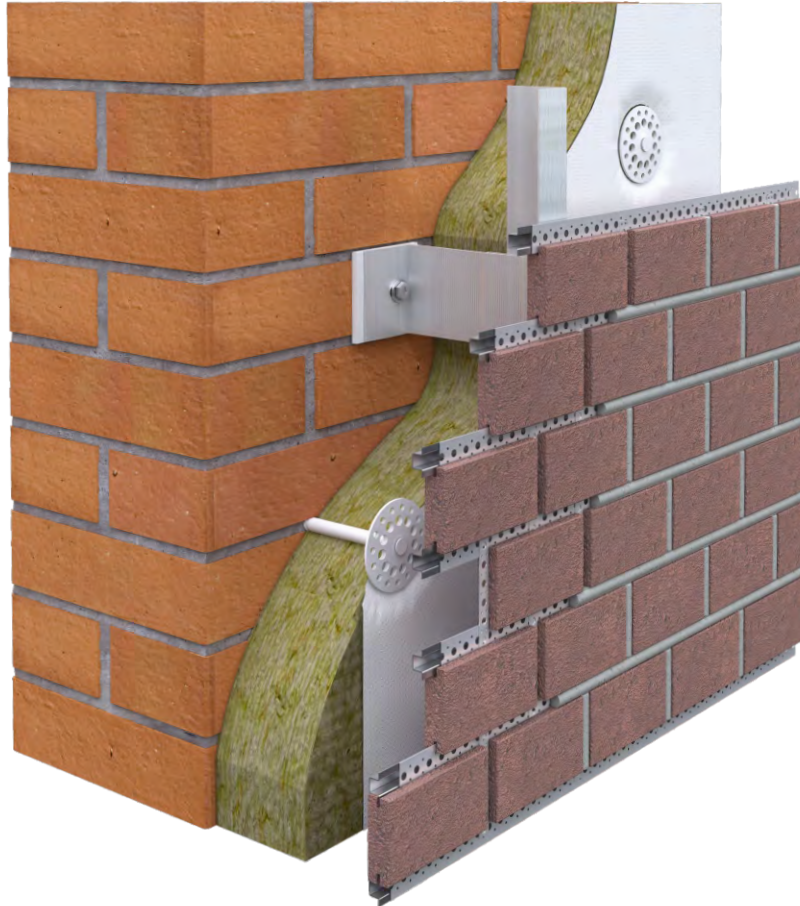

*Rustic joints are filled with finishing grout providing brick lining look both on main surface and on slopes.
Sizes of horizontal joints can be 10 and 12 mm.*

*Facing material: ceramic or concrete decorative clinker brick tiles.
Mounting configuration of facing material: bars with concealed mounting.
Max facing sizes: 400x200 mm (horizontally and vertically).
Offset of facing from the wall surface: 80 to 540mm.*

Mounting configuration of brackets:
- standard: mounting to the walls
- interfloor: mounting in the floor slabs.

Max allowed height: no height restrictions.

Slab-to-slab decorative clinker brick tiles frame fixing



*The absence of wet works makes installation considerably easier and faster all-year-round.
The difference between the facing and actual brick lining can be revealed by a closer look only.
Quick mounting and dismounting of tiles is made possible.*

*Facing material: notched ceramic or concrete decorative brick-look tiles.
Mounting configuration of facing material: bars with concealed mounting.
Max facing sizes: 400x200 mm(horizontally and vertically).
Offset of facing from the wall surface: 64 to 535mm.*

Mounting configuration of brackets:
- standard: mounting to the walls
- interfloor: mounting in the floor slabs.

Maximum allowed height: no height restrictions.

Visible fixing of 3-6mm porcelain tiles

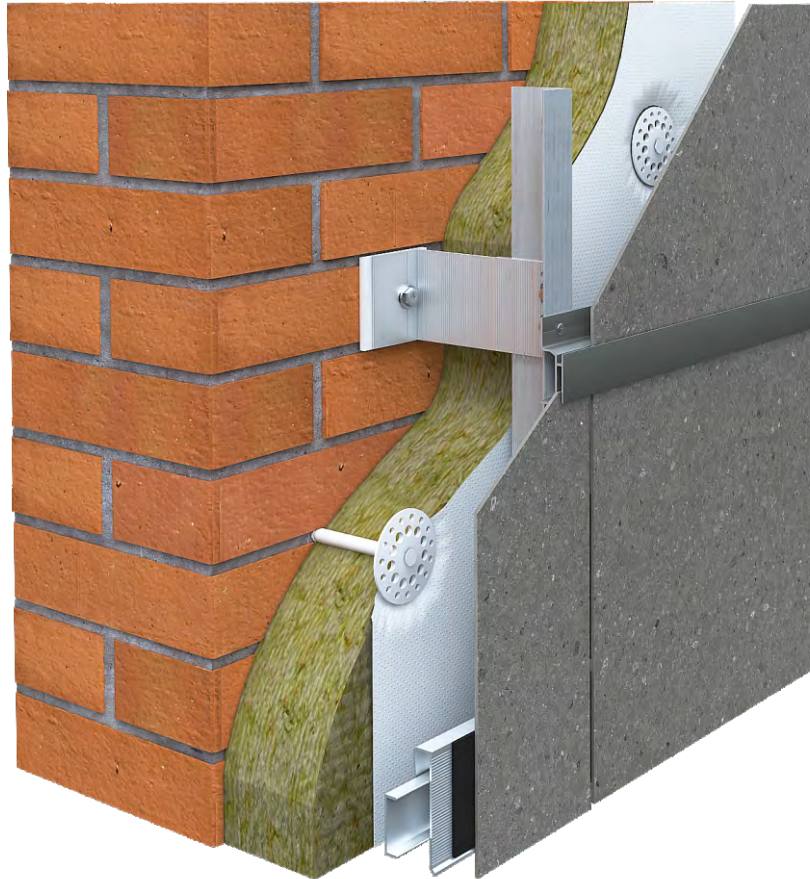

The system allows mounting large-size sheet materials over 3mm thick with dimensions of up to 3600x1800mm and bigger ones. Mixed, adhesive, and mechanical mounting is possible. Referencing of vertical joints to vertical sections of the system is not necessary, and facing may be staggered. The use of built-up bars ensures quick mounting and dismounting of panels.

Facing material: large-size ceramic granite tiles 3 to 6 mm thick.

Mounting configuration of facing material: mixed-type, using horizontal bars mechanically mounted and clips adhesive-mounted to facing tiles.

Max facing sizes: 1800x3600mm (horizontally and vertically).

Offset of facing from the wall surface: 67 to 520mm.

Mounting configuration of brackets:

- standard: mounting to the walls*
- interfloor: mounting in the floor slabs.*

Max allowed height: no height restrictions.

Cassette fixing of 3-6mm porcelain tiles



The system allows mounting large-size sheet materials over 3mm thick with dimensions of up to 3600x1800mm and bigger ones. Both just adhesive and mixed type (adhesive and mechanical) mounting is possible.

Facing material: large-size ceramic granite tiles 3 to 6 mm thick.

Mounting configuration of facing material: in cassettes made of aluminium sections.

Max facing sizes: 1800x3600mm (horizontally and vertically).

Offset of facing from the wall surface: 135 to 588mm.

Mounting configuration of brackets:

- standard: mounting to the walls

- interfloor: mounting in the floor slabs.

Max allowed height: no height restrictions.

Decorative finish plates fixing at sandwich panels



It is the only system on the market with Certificate of Validation for mounting onto external layer of sandwich panels. Various facing materials and mounting types are available.

Facing material: ceramic granite, HPL panels, fibre cement, zinc-plated steel sheets and cassettes, composite cassettes.

Mounting configuration of facing material: cleats, rivets, anchors, concealed self-tapping screws, adhesive mounting.

Max facing sizes: up to 3500x1500mm depending on material used.

Offset of facing from the wall surface: 50 to 350mm.

Mounting configuration to the base: support T-section or furring channels with brackets and extensions.

Max allowed height: no height restrictions.

Interfloor fixing system with the use of box-beam sections



*NordFox can be mounted with the use of brackets in interfloor slabs only.
Floor height is up to 6m.
Box-section is used.*

Interfloor fixing system with the use of I-beam (DT-beam) sections



*The system contains minimum number of parts. That makes the system easy to install.
Profile joint is outside of bracket, this allows placing horizontal rustic joint at any convenient location as to the floor height, thus the weakened section of interfloor connector is out of the maximum moment area.
Various section types are available in order to provide the optimum product for each individual case.
DT section is a T-section where the weight is distributed rationally along the section, which provides it with strength parameters similar to those of hollow sections, but lighter.
NordFox can be mounted with the use of brackets in interfloor slabs only, without wall-mounting.
Floor height is up to 6m.
H-section is used.*

MacFOX

MacFOX L

Fix point/flexible point bracket (large)

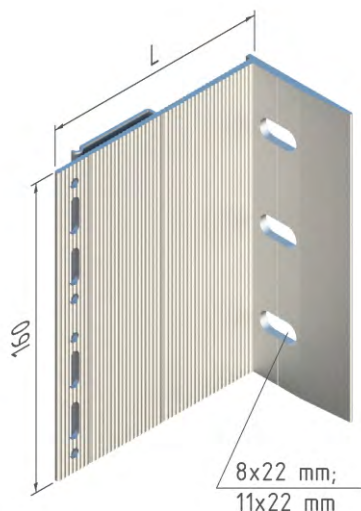

L	Code
40 mm	17/40L-11
60 mm	17/60L-11
90 mm	17/90L-11
120 mm	17/120L-11
150 mm	17/150L-11
180 mm	17/180L-11
210 mm	17/210L-11
240 mm	17/240L-11

MacFOX ML

Fix point/flexible point bracket (medium large)

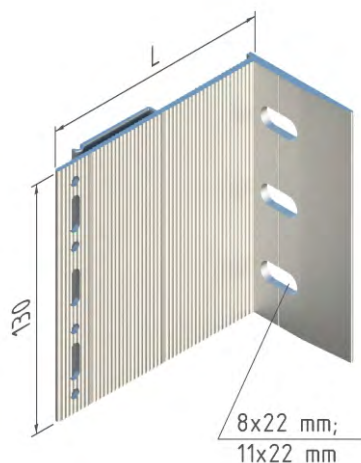

L	Code
40 mm	17/40ML-11
60 mm	17/60ML-11
90 mm	17/90ML-11
120 mm	17/120ML-11
150 mm	17/150ML-11
180 mm	17/180ML-11
210 mm	17/210ML-11
240 mm	17/240ML-11

MacFOX M

Fix point/flexible point bracket (medium)

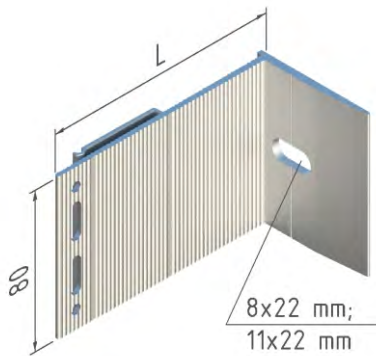

L	Code
40 mm	17/40M-11
60 mm	17/60M-11
90 mm	17/90M-11
120 mm	17/120M-11
150 mm	17/150M-11
180 mm	17/180M-11
210 mm	17/210M-11
240 mm	17/240M-11

MacFOX S

Flexible point bracket (small)

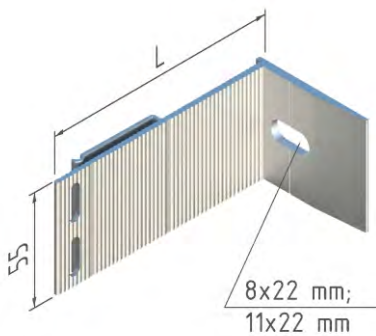

L	Code
40 mm	17/40S-11
60 mm	17/60S-11
90 mm	17/90S-11
120 mm	17/120S-11
150 mm	17/150S-11
180 mm	17/180S-11
210 mm	17/210S-11
240 mm	17/240S-11

XFOX

XFOX L

Fix point/flexible point bracket (large)

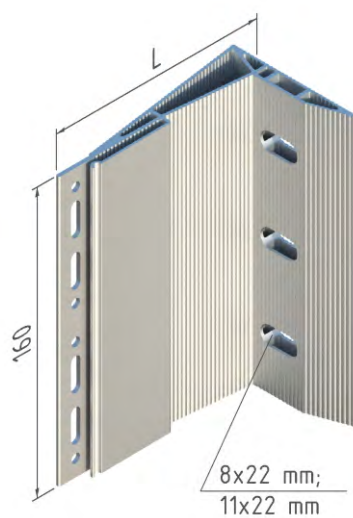

L	Code
150 mm	17/X150L-11
180 mm	17/X180L-11
210 mm	17/X210L-11

XFOX ML

Fix point/flexible point bracket (medium large)

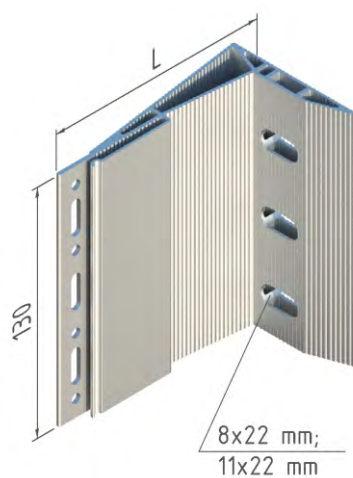

L	Code
150 mm	17/X150ML-11
180 mm	17/X180ML-11
210 mm	17/X210ML-11

XFOX M

Fix point/flexible point bracket (medium)

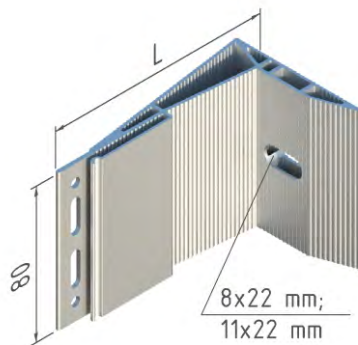

L	Code
150 mm	17/X150M-11
180 mm	17/X180M-11
210 mm	17/X210M-11

XFOX S

Flexible point bracket (small)

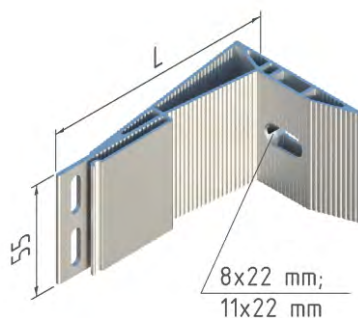

L	Code
150 mm	17/X150S-11
180 mm	17/X180S-11
210 mm	17/X210S-11

UFOX

UFOX L

Fix point bracket (large)

vertical floor to floor cladding application

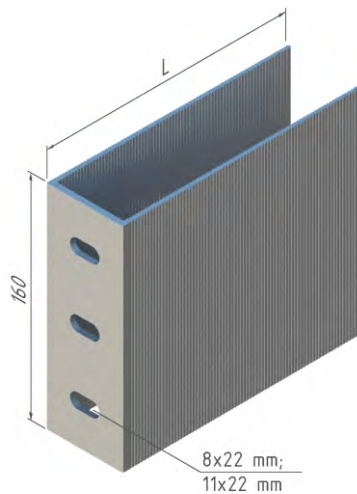

L	Code
80 mm	17/U80L-11 (8)
180 mm	17/U180L-11 (8)
230 mm	17/U230L-11 (8)

UFOX ML

Fix point bracket (medium large)

vertical floor to floor cladding application

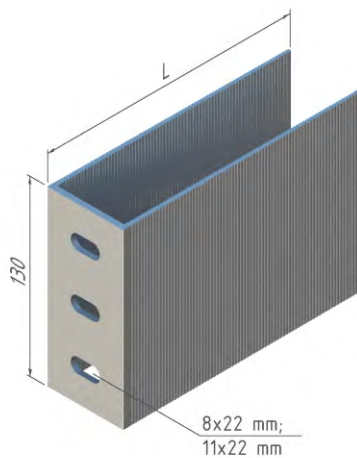

L	Code
80 mm	17/U80ML-11 (8)
180 mm	17/U180ML-11 (8)
230 mm	17/U230ML-11 (8)

UFOX M

Fix point bracket (medium)

vertical floor to floor cladding application

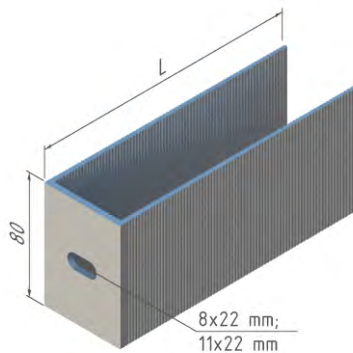

L	Code
80 mm	17/U80M-11 (8)
180 mm	17/U180M-11 (8)
230 mm	17/U230M-11 (8)

UFOX S

Fix point bracket (small)

vertical floor to floor cladding application

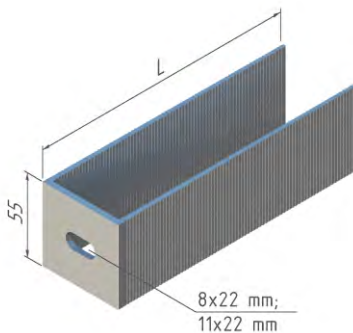

L	Code
80 mm	17/U80S-11 (8)
180 mm	17/U180S-11 (8)
230 mm	17/U230S-11 (8)

UTFOX

UTFOX L

Fix point bracket (large)

vertical floor to floor cladding application

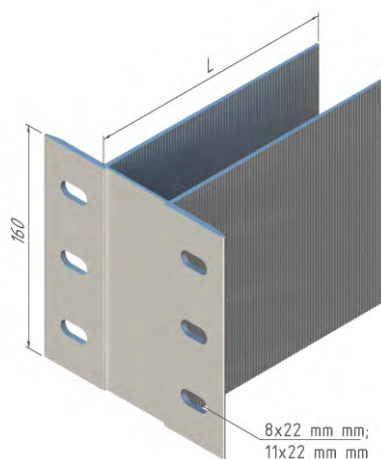

L	Code
80 mm	17/UT80L-11 (8)
180 mm	17/UT180L-11 (8)
230 mm	17/UT230L-11 (8)

UTFOX ML

Fix point bracket (medium large)

vertical floor to floor cladding application

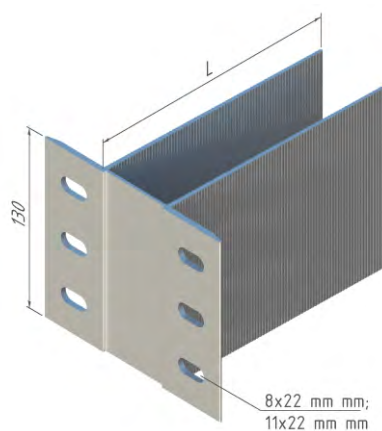

L	Code
80 mm	17/UT80ML-11 (8)
180 mm	17/UT180ML-11 (8)
230 mm	17/UT230ML-11 (8)

UTFOX M

Fix point bracket (medium)

vertical floor to floor cladding application

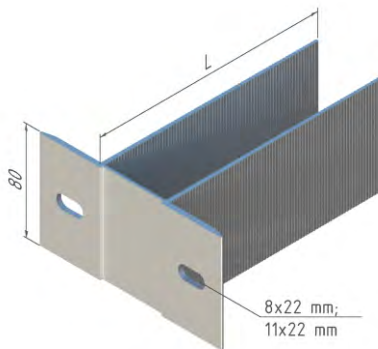

L	Code
80 mm	17/UT80M-11 (8)
180 mm	17/UT180M-11 (8)
230 mm	17/UT230M-11 (8)

UTFOX S

Fix point bracket (small)

vertical floor to floor cladding application

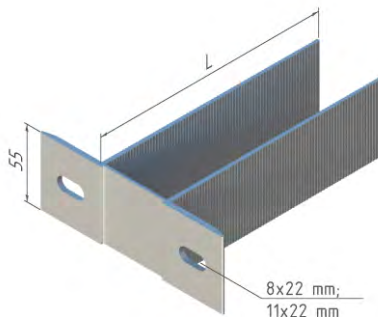

L	Code
80 mm	17/U80S-11 (8)
180 mm	17/U180S-11 (8)
230 mm	17/U230S-11 (8)

Thermal insulators

L (large)

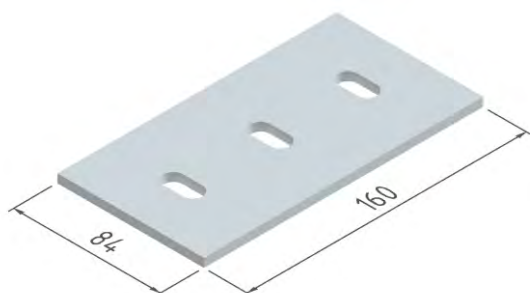

Code
10/Iso-L

ML (medium large)

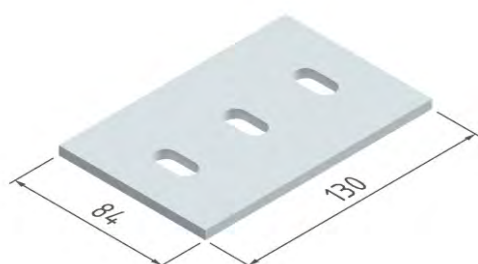

Code
10/Iso-ML

M (medium)

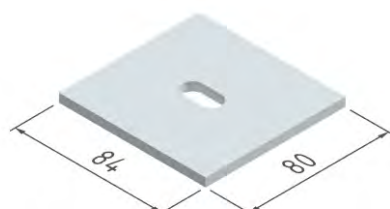

Code
10/Iso-M

MacDISFOX

MacDISFOX L

distance element (large)

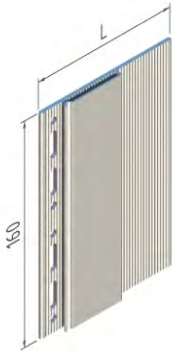

L	Code
106,5 mm	17/MDF-160
166,5 mm	17/MDF166-160

MacDISFOX ML

distance element (medium large)

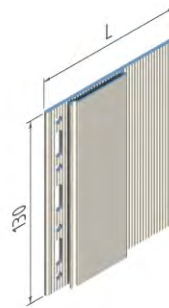

L	Code
106,5 mm	17/MDF-130
166,5 mm	17/MDF166-130

MacDISFOX M

distance element (medium)

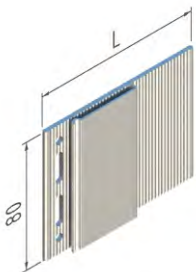

L	Code
106,5 mm	17/MDF-80
166,5 mm	17/MDF166-80

MacDISFOX S

distance element (small)

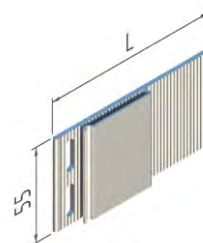

L	Code
106,5 mm	17/MDF-55
166,5 mm	17/MDF166-55

UDISFOX

vertical floor to floor cladding application

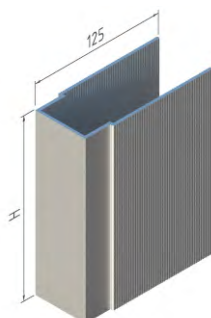

Size	H	Code
L (large)	160 mm	17/MDH-160
ML (medium large)	130 mm	17/MDH-130
M (medium)	80 mm	17/MDH-80
S (small)	55 mm	17/MDH-55

Confox

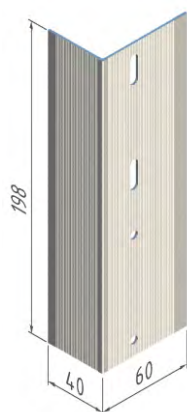

Code
17/MCF

Confox DT

vertical floor to floor cladding application

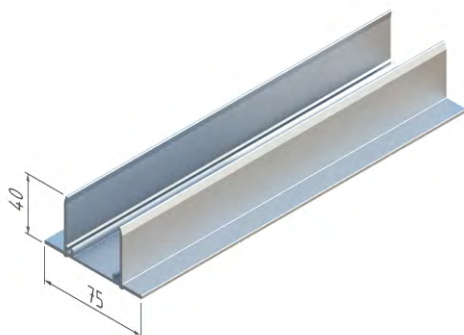

Code
17/MCF/76/D

Confox H

vertical floor to floor cladding application

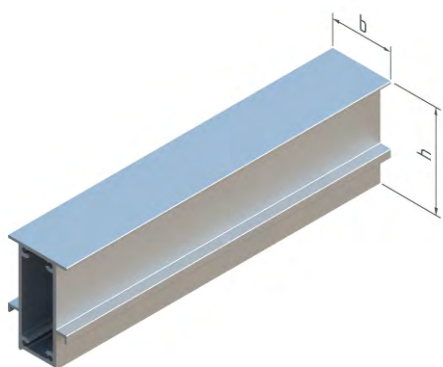

Code
17/MCF/73/46/250

T-profile

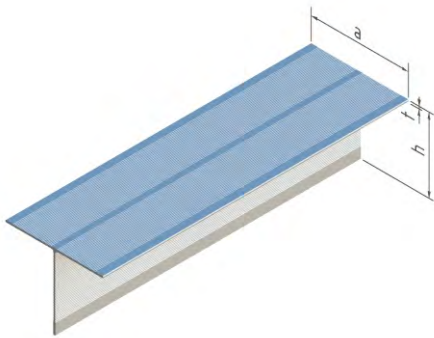

h	a	t	Code
62 mm	80 mm	2,1 mm	05/T62/80/2,1
62 mm	80 mm	1,8 mm	05/T62/80/1,8
40 mm	80 mm	1,8 mm	05/T40/80/1,8
62 mm	100 mm	2,1 mm	05/T62/100/2,1
62 mm	100 mm	1,8 mm	05/T62/100/1,8

L-profile

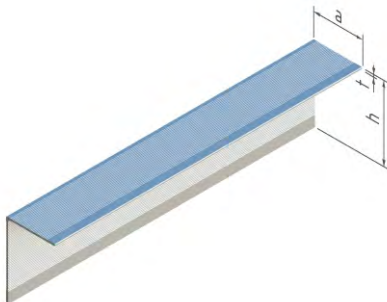

h	a	t	Code
62 mm	40 mm	2,1 mm	05/L62/40/2,1
62 mm	40 mm	1,8 mm	05/L62/40/1,8

K-profile

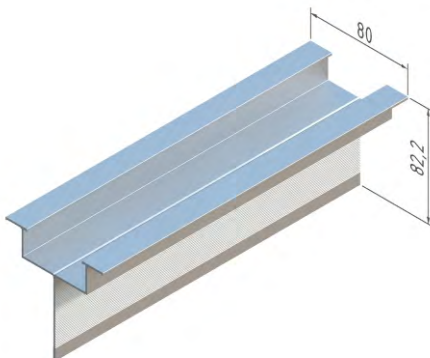

Code
05/K54/22

DT-profile

vertical floor to floor cladding application

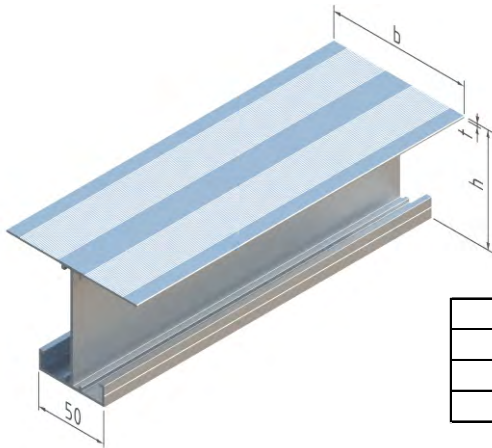

h	b	t	Code
80 mm	100 mm	1,8 mm	05/DT100/80/1,8
100 mm	100 mm	2,1 mm	05/DT100/100/2,1
130 mm	100 mm	1,8 mm	05/DT100/130/1,8

H-profile

vertical floor to floor cladding application

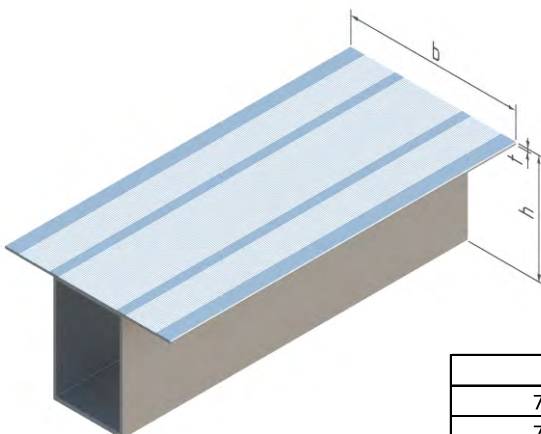

h	b	t	Code
79 mm	120 mm	2,1 mm	05/H120/79/50
78 mm	80 mm	2,1 mm	05/H80/78/50N

U-profile

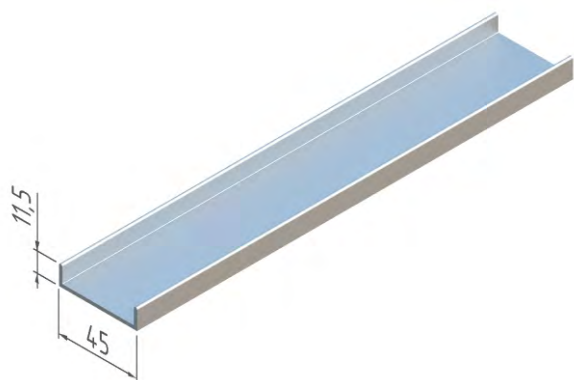

Code
05/U11,5/45/2

Hat-profile

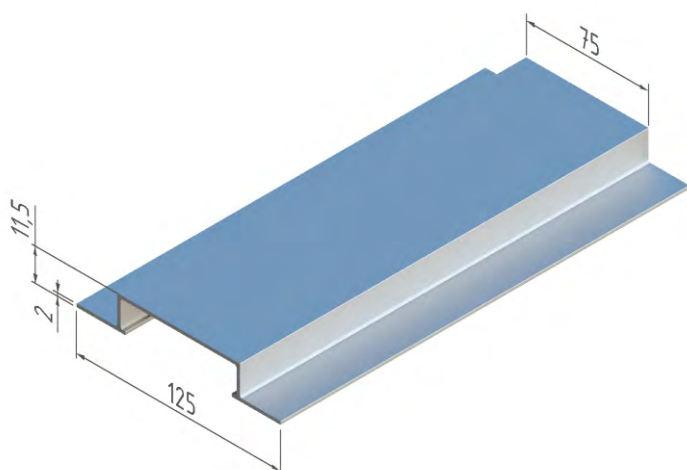

Code
05/Hat70/20/25

CX-profile

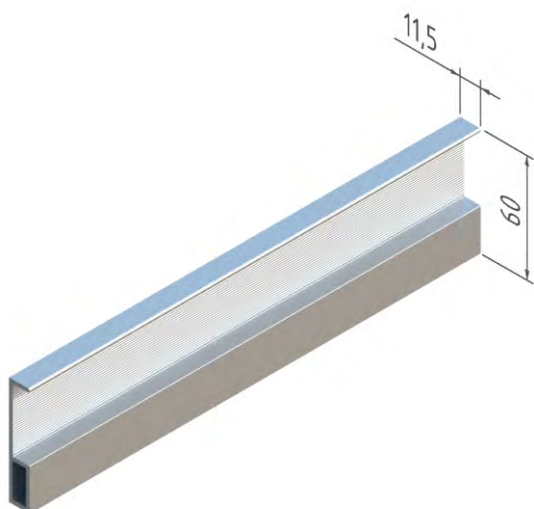

Code
05/CX-60

Trag-profile

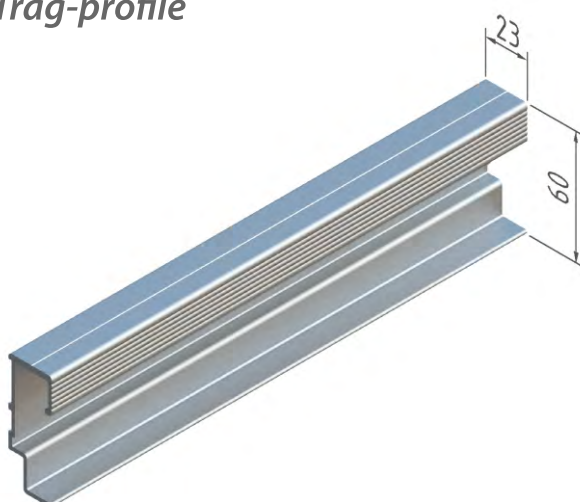

Code
05/A/Tragprofil (S5059)

Cassette profile # 1

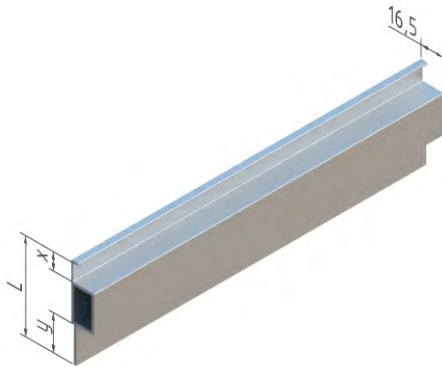

L	x	y	Code
64,2 mm	12 mm	25 mm	07/K26x17/1,9-1
59,2 mm	9 mm	23 mm	07/K26x17/1,9-1-2
59,2 mm	7 mm	25 mm	07/K26x17/1,9--1-3

Cassette profile # 2

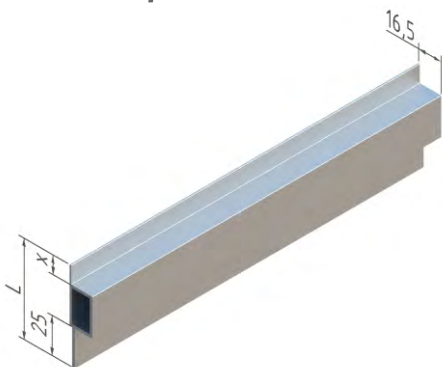

L	x	Code
62,7 mm	11,7 mm	07/K26x17/1,9-2
57,5 mm	6,5 mm	07/K26x17/1,9-2-1

Cassette profile # 3

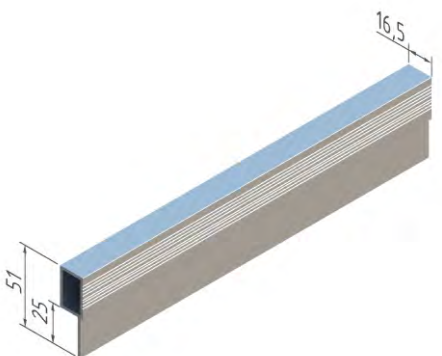

Code
07/K26x17/1,9-3

Holder profile

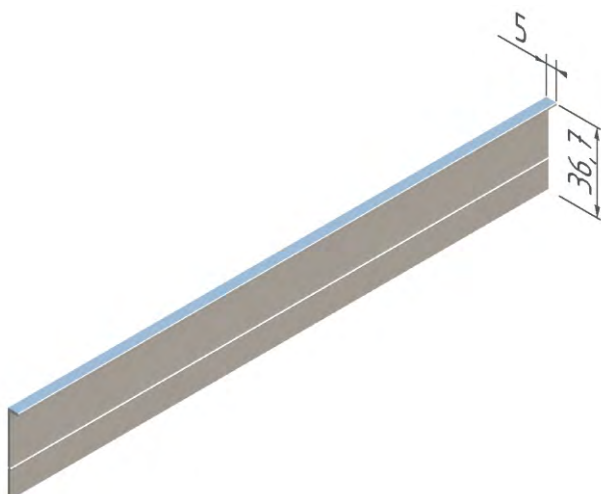

Code
07/KSC

Hollow profile 25x25x1,5

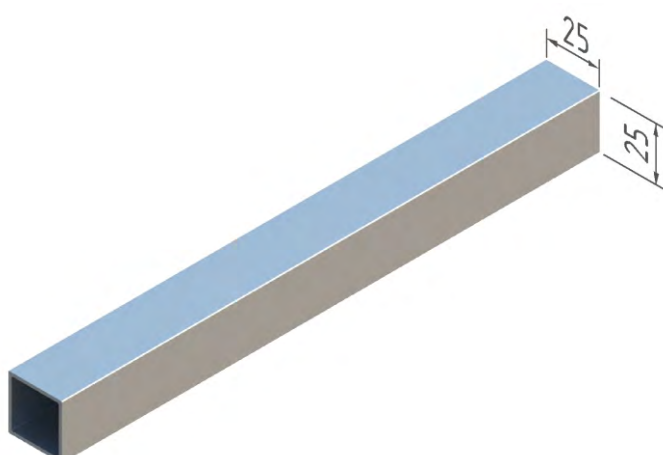

Code
Tube25x25x1,5

Z-profile for terracotta type 1

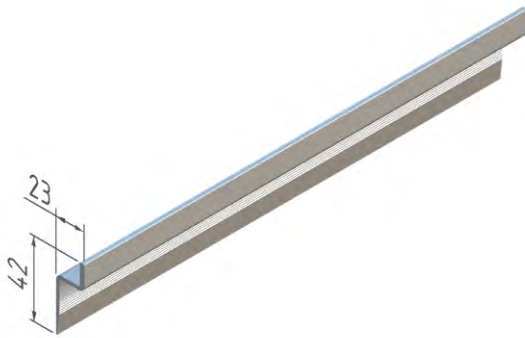

Code
07/Z14/16/30

Middle profile for clinker (stainless steel)

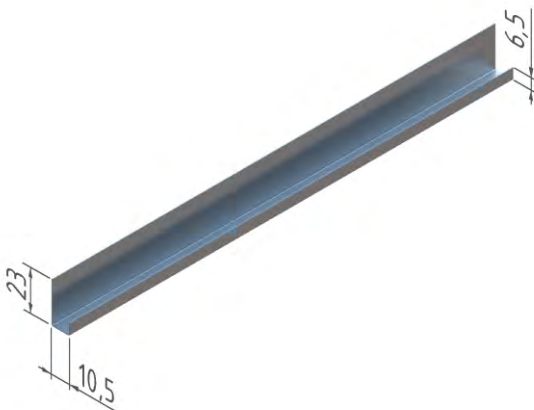

Code
05/KU10/ED

Top/bottom profile for clinker (stainless steel)

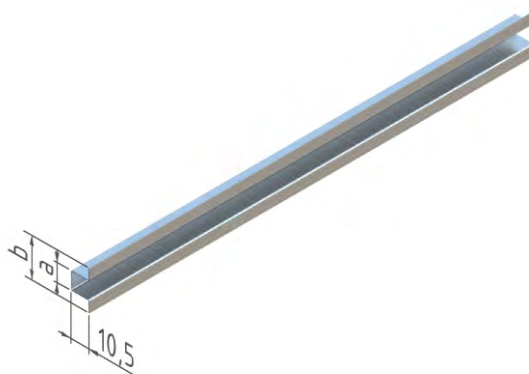

a	b	Code
10 mm	22 mm	05/KT10/ED-10
12 mm	24 mm	05/KT10/ED-12

Bottom profile for stone façade (aluminium)

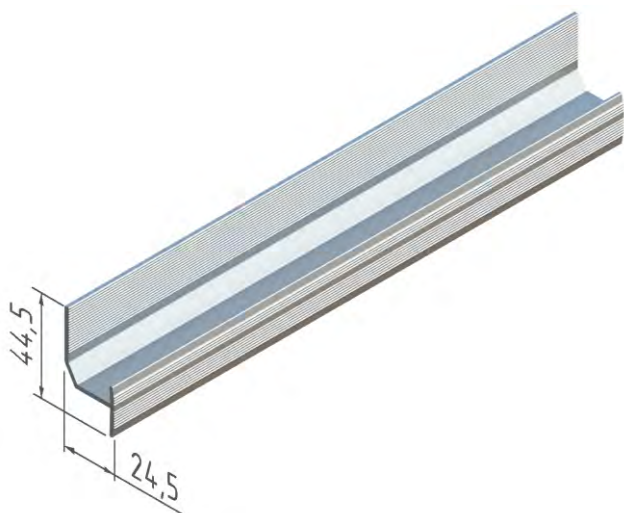

Code
05/KT23

Middle profile for stone façade (aluminium)

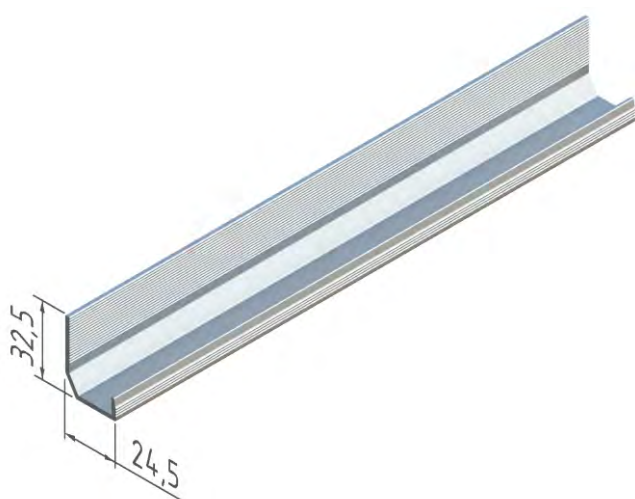

Code
05/KU23

Middle profile for ceramic slabs

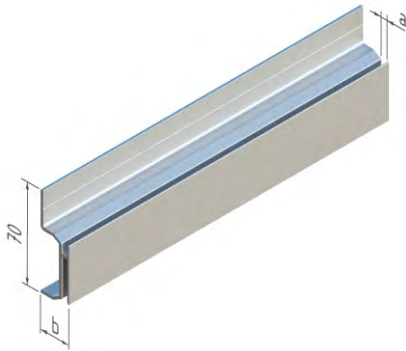

a	b	Code
4,5 mm	22,3 mm	05/S3,5
7 mm	24,8 mm	05/S6

Bottom profile for ceramic slabs

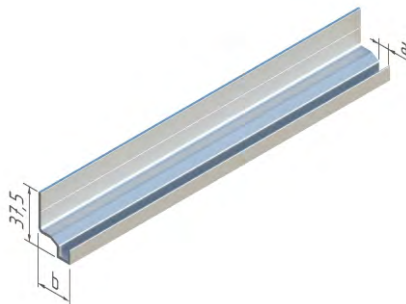

Code
05/SU6

Middle multipurpose profile for ceramic slabs

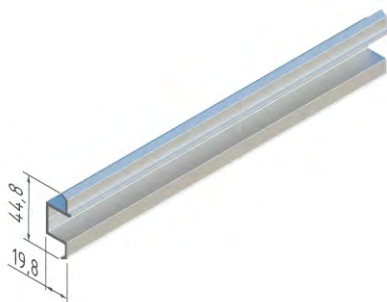

Code
05/SU

Holder profile for ceramic slabs

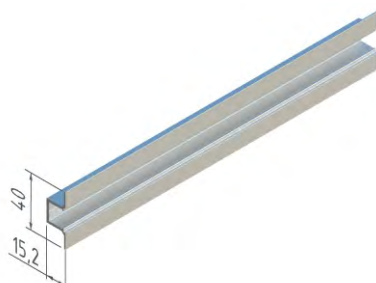

Code
05/SC

Clamp/profile rubber (tile thickness 6 mm)



Code
09/PR-6

Clamp/profile rubber (tile thickness 8 mm)



Code
09/PR-8

Clamp/profile rubber (tile thickness 11 mm)



Code
09/PR-11

*Bottom clamp for terracotta
(stainless steel)*

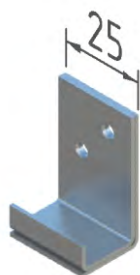

Code
07/KU18/25E

*Middle clamp for terracotta
(stainless steel)*



Code
07/KT18/25E

*Top clamp for terracotta
(stainless steel)*



Code
07/KF18/25E

Clamp type 1 (aluminium)

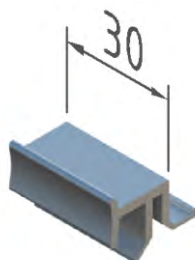

Code
07/KAGR1

Clamp type 5 (aluminium)

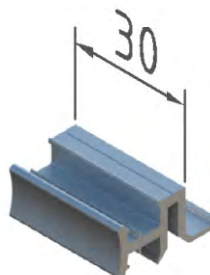

Code
07/KAGR5

*Middle clamp for terracota type 2
(aluminium)*



a	Code
14 mm	07/KAR-L
17 mm	07/KAR-L-1

*Bottom clamp for terracota type 2
(aluminium)*

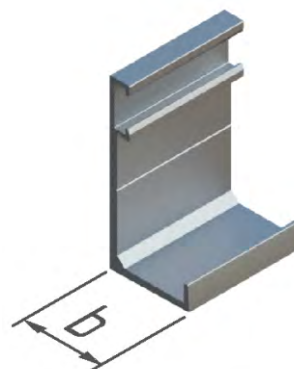

b	Code
20,9 mm	07/KAU-L
24,9 mm	07/KAU-L-2

*Top clamp for terracota type 2
(aluminium)*

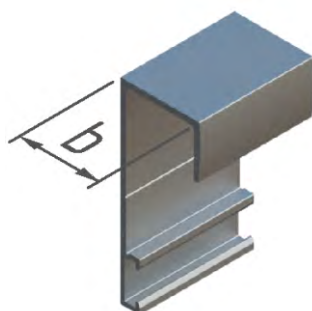

b	Code
21 mm	07/KAO-L
25 mm	07/KAO-L-2

*Middle clamp for terracota type 3
(aluminium)*

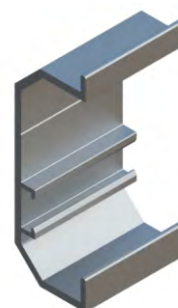

Code
07/KATR-L

Middle clamp for ceramic facade (stainless steel)

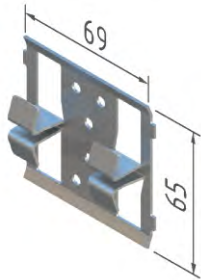

Tile thickness	Code
8 mm	07/KEM4-8/13
10 mm	07/KEM4-10/13
12 mm	07/KEM4-12/13
13,5 mm	07/K2M4-13,5/15/1,2
16 mm	07/KEM4-16/16

Bottom clamp for ceramic facade (stainless steel)

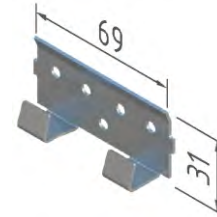

Tile thickness	Code
8 mm	07/KEU4-8/13
10 mm	07/KEU4-10/13
12 mm	07/KEU4-12/13
13,5 mm	07/K2U4-13,5/15/1,2
16 mm	07/KEU4-16/16

Corner clamp for ceramic facade (stainless steel)

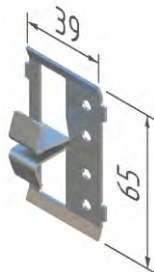

Tile thickness	Code
8 mm	07/KER4-8/13
10 mm	07/KER4-10/13
12 mm	07/KER4-12/13
13,5 mm	07/K2R4-13,5/15/1,2
16 mm	07/KER4-16/16

Special middle clamp for ceramic facade (stainless steel)

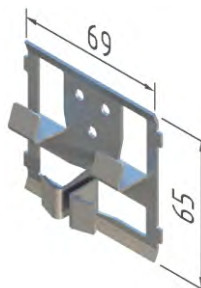

Tile thickness	Code
8 mm	07/KEM4-8/13S
10 mm	07/KEM4-10/13S
12 mm	07/KEM4-12/13S
13,5 mm	07/K2M4-13,5/15/1,2S

Special bottom/corner clamp for ceramic facade (stainless steel)

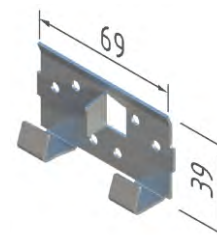

Tile thickness	Code
8 mm	07/KEU4-8/13S
10 mm	07/KEU4-10/13S
12 mm	07/KEU4-12/13S
13,5 mm	07/K2U4-13,5/15/1,2S

Slide holder

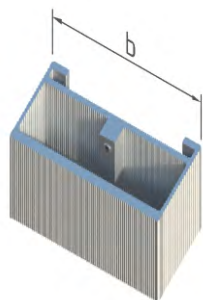

b	Code
85,5 mm	17/S40-F
105,5 mm	17/S40-100F

Position holder type 2



Code
17/SC18-F

Cassette hanger



Code
14/I

Cassette hanger type 2



Code
14/I2

Cassette hook

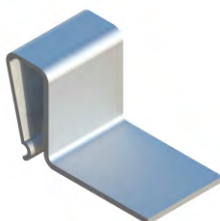

Code
14/FS

Holder profile cap



Code
05/CP

Clip

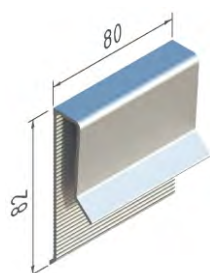

Code
14/FS-C

Hanger (for U-profile)

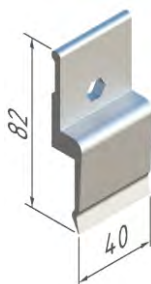

Type of anchor	Code
Keil	13/ASK40
Ejot Duro-PT	13/ASK40-RL

Hanger (for Trag-profile)

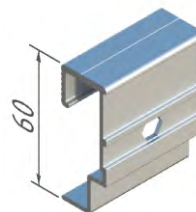

Type of anchor	Code
Keil	13/AS
Ejot Duro-PT	13/AS/60RL

Leveling hanger (for U-profile)

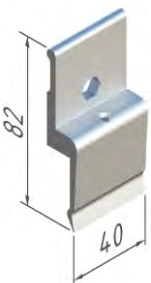

Type of anchor	Code
Keil	13/AJK40
Ejot Duro-PT	13/AJK40-RL

Leveling hanger (for Trag-profile)

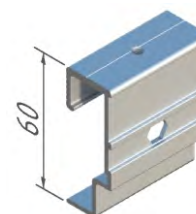

Type of anchor	Code
Keil	13/AJ
Ejot Duro-PT	13/AJ/60RL

Leveling and fixing hanger (for U-profile)

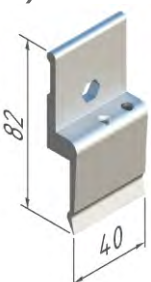

Type of anchor	Code
Keil	13/AJK40-F
Ejot Duro-PT	13/AJK40-RL-F

Leveling and fixing hanger (for Trag-profile)

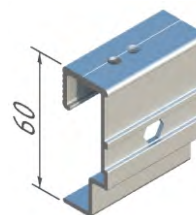

Type of anchor	Code
Keil	13/AJ-F
Ejot Duro-PT	13/AJ/60RL-F

Mounting element
60x50x40 mm

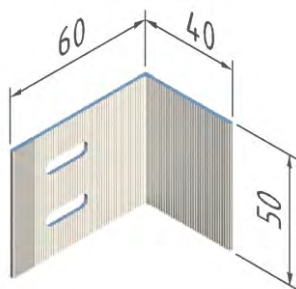

Code
20/9100

Mounting element
80x50x30 mm

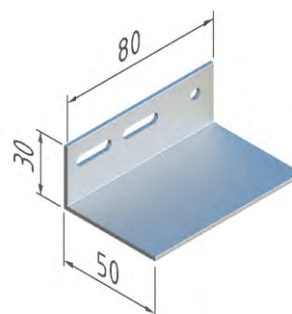

Code
20/305080

Mounting element
50x50x25 mm

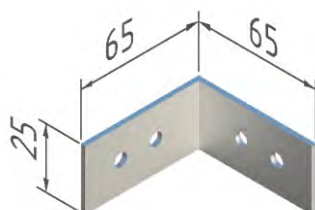

Code
20/505025

Corner connection element
for cassette profiles

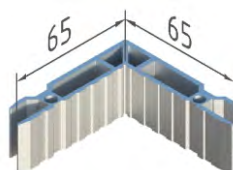

Code
14/RK-CK



C.M.I. srl - via Radici in Piano n. 556 - 41049 Sassuolo (MO) ITALY - P.IVA 03630230369
Tel1 +39 0536 905 353 - Fax Comm. +39 0536 917 589 - Fax Amm. +39 0536 812 273 - www.emosgroup.it - info@emosgroup.it